

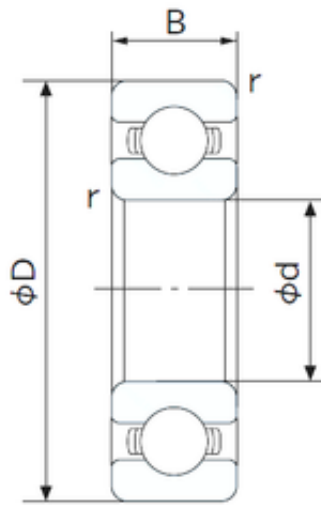

## China 608zz Bearing Supplier



SKF NSK Timken Koyo NACHI NTN Ssr  
 Bearing 6201 6203 6205 6207 6209 6211 6007 6305  
 6307 6309 6311 Wear Resistant High Quality Ball  
 Bearing

Bearing No. 6201

6201 Bearing 2D drawings and 3D CAD models

Size	12x32x10 mm
Bore Diameter	12 mm
Outer Diameter	32 mm
Width	10 mm
d	12 mm
D	32 mm
B	10 mm
C	10 mm
r min.	0.6 mm
da min.	17 mm
Da max.	27 mm
ra max.	0.6 mm
Weight	0.037 Kg
Basic dynamic load rating (C)	6,8 kN
Basic static load rating (C0)	3,05 kN
(Grease) Lubrication Speed	22000 r/min
Category	Single Row Ball Bearings
Inventory	0.0
Manufacturer Name	NACHI
Minimum Buy Quantity	N/A
Weight / Kilogram	0
Product Group	B00308
Enclosure	Open



## China 608zz Bearing Supplier

Precision Class	ABEC 1   ISO P0
Maximum Capacity / Filling Slot	No
Rolling Element	Ball Bearing
Snap Ring	No
Internal Special Features	No
Cage Material	Steel
Internal Clearance	C0-Medium
Inch - Metric	Metric
Long Description	12MM Bore; 32MM Outside Diameter; 10MM Outer Race Width; Open; Ball Bearing; ABEC 1   ISO P0; No Filling Slot; No Snap Ring; No Internal Special Features; C0-Medium Internal Clearance; Steel Cage
Other Features	Deep Groove
Category	Single Row Ball Bearing
UNSPSC	31171504
Harmonized Tariff Code	8482.10.50.68
Noun	Bearing
Keyword String	Ball
Manufacturer URL	<a href="http://www.nachiamerica.com">http://www.nachiamerica.com</a>
Weight / LBS	0.081
Bore	0.472 Inch   12 Millimeter
Outside Diameter	1.26 Inch   32 Millimeter
Outer Race Width	0.394 Inch   10 Millimeter
Inner Race Width	0 Inch   0 Millimeter
Bore Type	Cylindrical Bore
Configuration	Single Row
Bore Size	12 mm
Width	10 mm



## China 608zz Bearing Supplier

Fillet Radius/Chamfer	0.6 mm
Dynamic Load Rating	6,800 N
Static Load Rating	3,050 N
Limiting Speed - Grease	22,000 rpm
Limiting Speed - Oil	28,000 rpm
Factor fo	12.3
Radial Clearance	0.003 to 0.018 mm
da (min)	17 mm
Da (max)	27 mm
ra (max)	0.6 mm